

HOW IS THE BALLOT PAPER MARKED?

VOTERS WILL SELECT ONLY ONE LIST ON THE BALLOT PAPER BY MARKING THE SQUARE BOX NEXT TO THAT LIST WITH AN (X). VOTERS SHOULD BE CAUTIOUS THAT:

- THE X SHOULD BE PLACED WITHIN THE BOUNDARY OF THE SQUARE.
- THE BALLOT PAPER IS NOT DAMAGED OR STAINED WITH INK.



WHEN WILL THE LEGISLATIVE ELECTIONS TAKE PLACE?

VOTING WITHIN THE TUNISIAN REPUBLIC WILL TAKE PLACE ON SUNDAY THE **26TH OF OCTOBER 2014**. THE VOTING WILL TAKE PLACE ON ONE DAY ONLY, WHICH WILL BE A PUBLIC HOLIDAY.

VOTING WILL BEGIN AT 7:00 AM
AND END AT 18:00 PM



OUT-OF-COUNTRY VOTING WILL TAKE PLACE OVER **3 DAYS**, WHICH WILL BE THE **24TH, 25TH AND 26TH OF OCTOBER 2014**.

OUT-OF-COUNTRY VOTING WILL BEGIN
AT 8:00 AM AND END AT 18:00 PM.



WHERE WOULD THE LEGISLATIVE ELECTIONS TAKE PLACE ?

VOTERS SHOULD CAST THEIR BALLOTS AT THE POLLING CENTER THAT THEY CHOSE WHEN THEY REGISTERED ON THE VOTERS' LIST. FOR IN-COUNTRY VOTING, POLLING CENTERS ARE LOCATED IN PRIMARY, SECONDARY AND HIGH SCHOOLS. FOR OUT-OF-COUNTRY VOTING POLLING CENTERS ARE LOCATED IN TUNISIAN CONSULATES OR DIPLOMATIC MISSIONS OR ANY OTHER LOCATION ABROAD THAT THE IRIE HAD ANNOUNCED.

TO VERIFY YOUR POLLING CENTER, THE NUMBER OF YOUR POLLING STATION AND YOUR RANK ON THE VOTERS' LIST YOU CAN USE THE FREE MOBILE SERVICE A ***195*CIN#** IF YOU ARE REGISTERED TO VOTE IN-COUNTRY. BOTH IN-COUNTRY AND OUT-OF-COUNTRY VOTERS CAN VERIFY THE SAME INFORMATION ON THE ONLINE SERVICE

<https://touenssa.isie.tn>

WHAT DOCUMENTS SHOULD VOTERS CARRY WITH THEM TO VOTE ?

EACH VOTER MUST PRESENT HIS (HER) NATIONAL IDENTIFICATION CARD OR PASSPORT AT THE POLLING CENTER.



انتخابات
2014
التشريعية

POLLING STEPS

The polling process is observed by electoral observers and candidate lists' representatives



1
Queuing and entering
the polling station



2
Verification of the voter's ID
and signing the voters' list



3
Applying the elector ink



6
Placing the ballot paper inside the ballot box
and leaving the polling station and centre

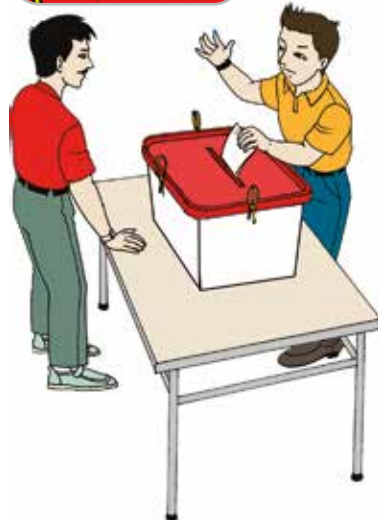

5
Marking your choice and folding the
ballot paper inside the polling booth

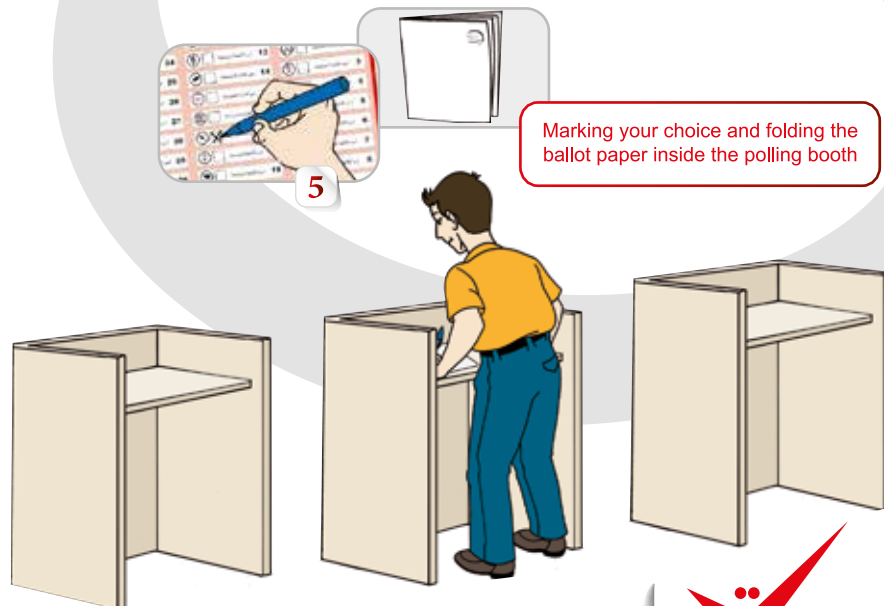

4
Obtaining a ballot paper
stamped on its four corners

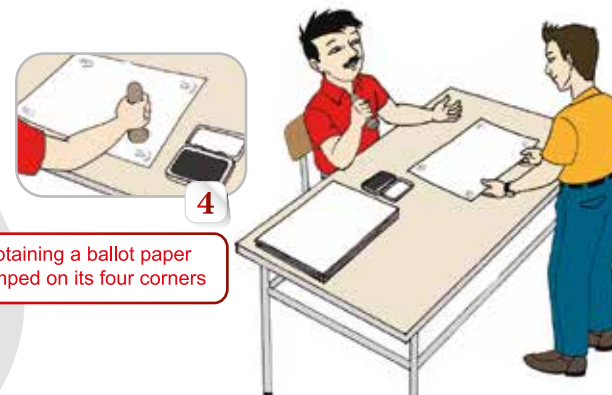

WHAT ARE THE LEGISLATIVE ELECTIONS?

THE LEGISLATIVE ELECTIONS ARE ABOUT ELECTING THE MEMBERS OF THE PEOPLE'S REPRESENTATIVES ASSEMBLY, FOR A 5 YEAR TERM, IN 27 ELECTOR DISTRICTS WITHIN TUNISIA AND 6 ELECTOR DISTRICTS ABROAD THROUGH OUT-OF-COUNTRY VOTING.

HOW IS THE PEOPLE'S REPRESENTATIVES ASSEMBLY COMPOSED ?

IT IS COMPOSED OF 217 MEMBERS OF WHOM 199 ARE ELECTED WITHIN THE ELECTOR DISTRICTS IN TUNISIA WHILE 18 ARE ELECTED WITHIN THE ELECTORAL DISTRICTS ABROAD.

WHAT IS THE ROLE OF THE PEOPLE'S REPRESENTATIVES ASSEMBLY ?

1 - TO EXERCISE LEGISLATIVE AUTHORITY, WHICH MEANS ISSUING LAWS (BOTH ORDINARY AND BASIC LAWS). THESE INCLUDE THE FINANCE CODE AS WELL AS LAWS GOVERNING RIGHTS AND FREEDOMS.

2 - TO PROVIDE OVERSIGHT OVER THE EXECUTIVE AUTHORITY, I.E THE GOVERNMENT, WITH THE ABILITY TO SET FORTH MOTIONS OF NO-CONFIDENCE IN A GOVERNMENT.

WHO HAS THE RIGHT TO VOTE ?

ANY TUNISIAN WHO IS AT LEAST 18 YEARS OLD AS OF ONE DAY PRIOR TO ELECTION DAY AND WHO IS REGISTERED IN THE VOTERS' LIST AND WHO IS NOT SUBJECT TO ANY OF THE LEGAL CONDITIONS THAT DEPRIVE HIM OR HER FROM THE RIGHT TO VOTE.